

withdrawable circuit breaker with guide frame 3-pole, size I, IEC In=630A to 690V, AC50/60Hz Icu=66kA at 500V rear connection horizontal Overcurrent release ETU 25 LSI protection adjustable 0.4-1 in With manual operating mechanism with storage with mechanical request without 1st auxiliary release without 2nd auxiliary release 4NO+4NC



Model		
Product brand name		SENTRON
Product designation		ACB
Design of the product		IEC 60947-2
Design of the auxiliary switch		4 NO + 4 NC
Design of the operating mechanism		Pushbutton

Type of the driving mechanism		Manual operating mechanism with mechanical closing
Type of the driving mechanism / motor drive		No
Design of the overcurrent release		ETU25B

#### General technical data

Number of poles		3
Size of the circuit-breaker		1
Electrical endurance (switching cycles) / typical		20 000
Usage category		B
circuit-breaker / Design		3WL1
Mechanical service life (switching cycles) / typical		20 000

#### Voltage

Rated insulation voltage $U_i$	V	1 000
--------------------------------	---	-------

#### Protection class

Protection class IP		IP20
Protective function of the overcurrent release		LSI

#### Dissipation

Power loss [W] / for rated value of the current / at AC / in hot operating state / per pole	W	65
---	---	----

#### Electricity

Operating current / at 45 °C / rated value	A	630
Continuous current / rated value	A	630
Adjustable pick-up value current		
• of the current-dependent overload release / Full-scale value	A	630
• of instantaneous short-circuit trip unit / initial value	A	12 600
• of instantaneous short-circuit trip unit / Full-scale value	A	12 600
Short-time current resistance ( $I_{cw}$ )		
• limited to 0.5 s / rated value	kA	66
• limited to 1 s / rated value	kA	50
• limited to 2 s / rated value	kA	35
• limited to 3 s / rated value	kA	29

#### Main circuit

Operating frequency		
• 1 / rated value	Hz	50
• 2 / rated value	Hz	60
Operating voltage		
• at AC / at 50/60 Hz / rated value	V	690
Operating current		

• at 40 °C / rated value	A	630
• at 50 °C / rated value	A	630
• at 55 °C / rated value	A	630
• at 60 °C / rated value	A	630
• at 65 °C / rated value	A	630
• at 70 °C / rated value	A	630

#### Auxiliary circuit

Number of NC contacts / for auxiliary contacts		4
Number of NO contacts / for auxiliary contacts		4

#### Suitability

Suitability for use		Plant / motor protection
---------------------	--	--------------------------

#### Adjustable parameters

Adjustable pick-up value current / of the current-dependent overload release / initial value	A	252
--	---	-----

#### Product details

Product component		
• Trip indicator		Yes
• Voltage trigger		No
• undervoltage release		No
Product extension / optional / motor drive		Yes

#### Product function

Product function		
• Ground fault protection		No
• Phase failure detection		Yes

#### Display and operation

Display version		without display
-----------------	--	-----------------

#### Short circuit

Operational short-circuit current breaking capacity (Ics)		
• at 415 V / rated value	kA	66
• at 500 V / rated value	kA	66
• at 690 V / rated value	kA	50
Maximum short-circuit current breaking capacity (Icu)		
• at 415 V / rated value	kA	66
• at 500 V / rated value	kA	66
• at 690 V / rated value	kA	50

#### Connections

Type of electrical connection / for main current circuit		busbar connection
--	--	-------------------

#### Mechanical Design

Height	mm	460
Width	mm	320
Depth	mm	456
Mounting type		drawer unit

### Environmental conditions

Ambient temperature		
• during operation / minimum	°C	-20
• during operation / maximum	°C	70
• during storage / minimum	°C	-40
• during storage / maximum	°C	70

### Certificates

Reference code		
• acc. to DIN EN 61346-2		Q
• acc. to DIN EN 81346-2		Q
Waste electronic equipment must not be disposed as unsorted municipal waste, e.g. household waste. For disposing the waste electronic equipment it is necessary to observe the current local national/international regulations.		
		

General Product Approval	Declaration of Conformity	Test Certificates
--------------------------	---------------------------	-------------------



[Miscellaneous](#)

[Special Test Certificate](#)

### Shipping Approval



Shipping Approval	other
-------------------	-------



[Environmental Confirmations](#)

[Manufacturer Declaration](#)

[Miscellaneous](#)

### Further information

**Industry Mall (Online ordering system)**

<https://mall.industry.siemens.com/mall/en/en/Catalog/product?mlfb=3WL1106-3CB36-1AA4>

**Service&Support (Manuals, Certificates, Characteristics, FAQs,...)**

<https://support.industry.siemens.com/cs/ww/en/ps/3WL1106-3CB36-1AA4>

**Image database (product images, 2D dimension drawings, 3D models, device circuit diagrams, ...)**

[http://www.automation.siemens.com/bilddb/cax\\_en.aspx?mlfb=3WL1106-3CB36-1AA4](http://www.automation.siemens.com/bilddb/cax_en.aspx?mlfb=3WL1106-3CB36-1AA4)

**CAX-Online-Generator**

<http://www.siemens.com/cax>

**Tender specifications**

<http://www.siemens.com/specifications>

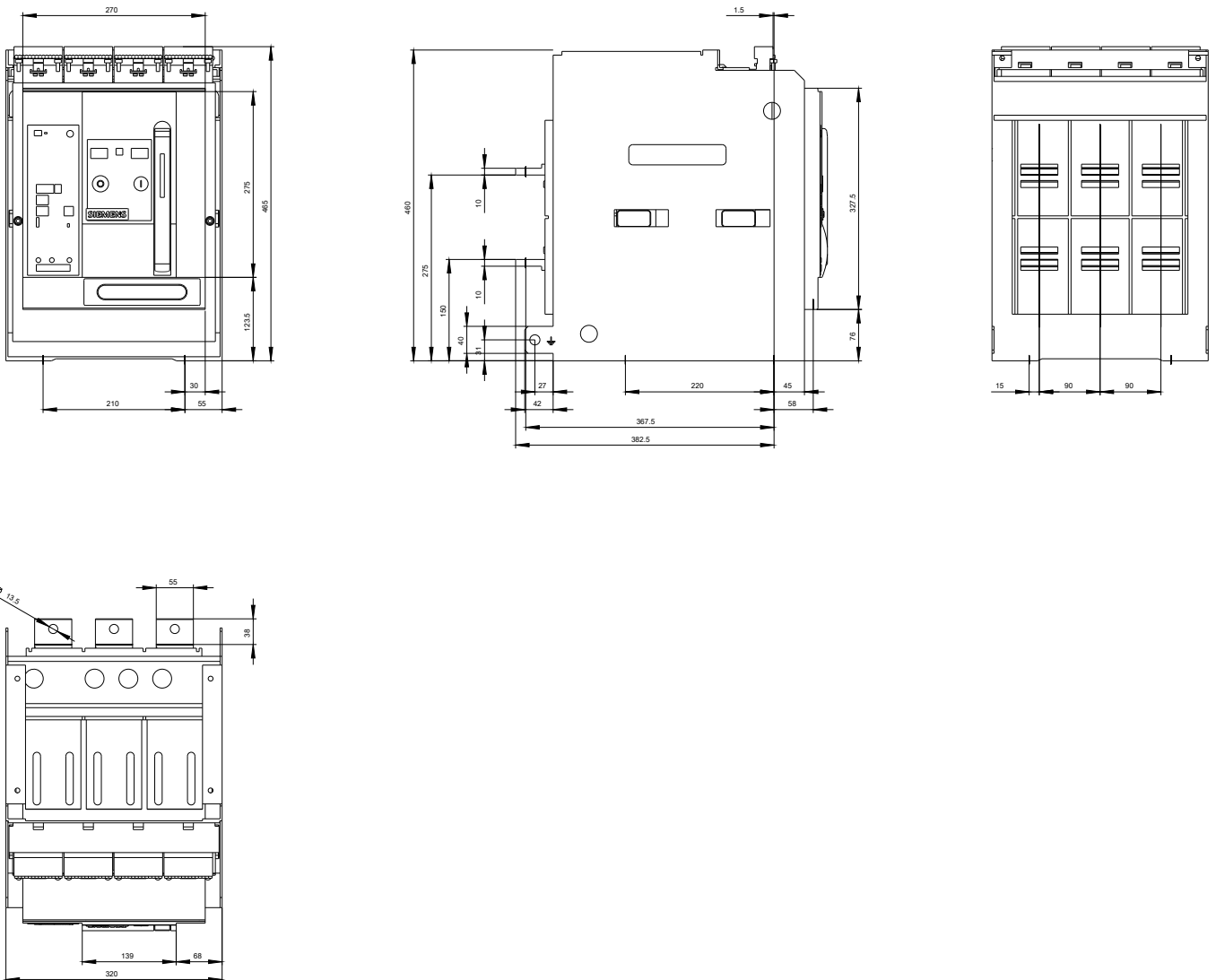

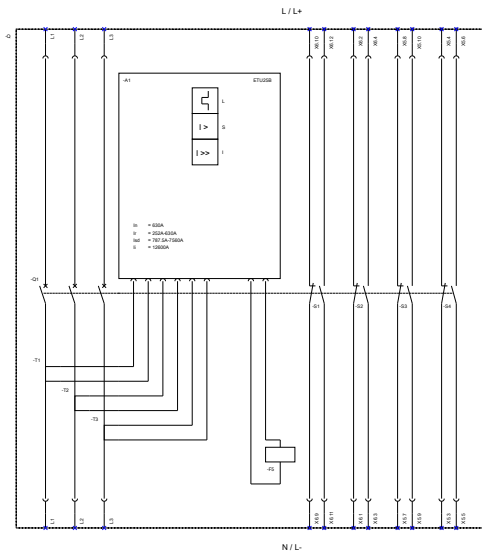

**last modified:**

02/01/2019