

# E1101S

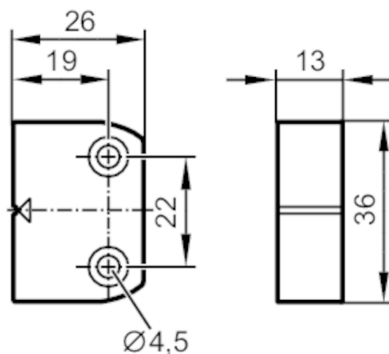

## magnetically coded target

DEFINED TARGET MN2xxS



### Application

Installation for magnetic sensor MN2

### Mechanical data

Weight	[g]	56
Dimensions	[mm]	36 x 13 x 26
Materials		PA
Tightening torque	[Nm]	0.8...2

### Remarks

Pack quantity 1 pcs.