

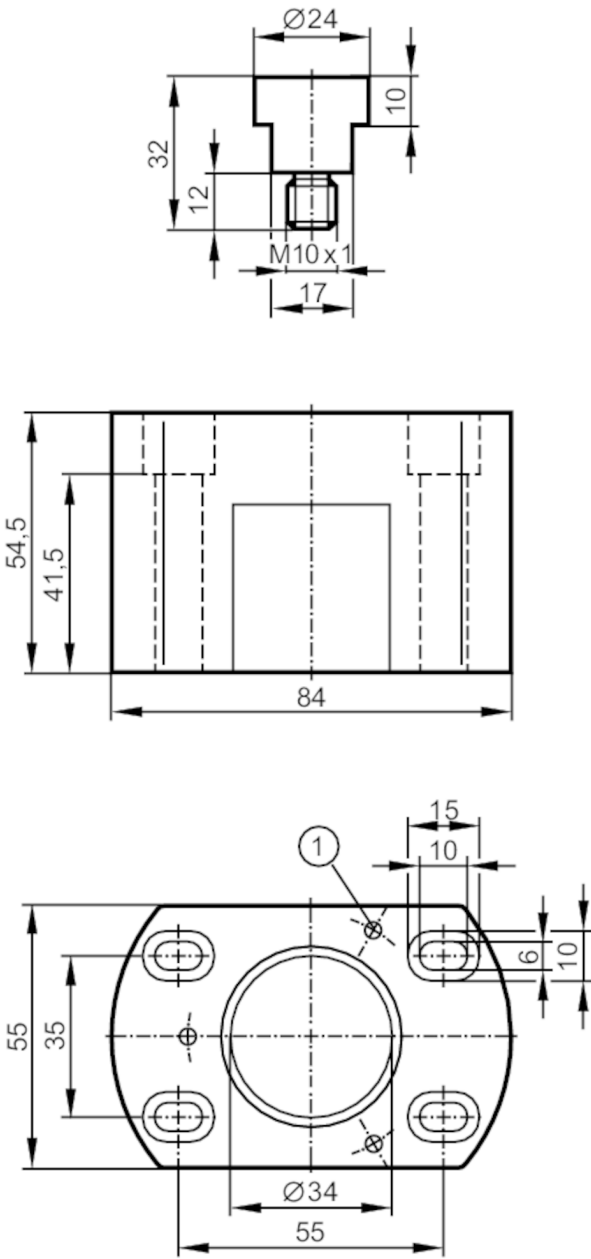

Mounting adapter for position sensors used on rising  
stem valves

ADAPTER VALVIS\_05

Status Archive



1      bore hole to fix the valve sensor on the adapter

Application	
Design	accessories for IX5010, IX5030
Mechanical data	
Weight	[g] 375.4
Dimensions	[mm] 54.5 x 55 x 84
Materials	Adapter: PA; Target: stainless steel (1.4404 / 316L)

E11989



Mounting adapter for position sensors used on rising stem valves

ADAPTER VALVIS\_05

Accessories	
Accessories (supplied)	screws: 3, thread forming
	socket head screws: 4 x M5 x 45, stainless steel
	O-ring:, FKM
	sealing plugs
Remarks	
Notes	discontinued article
Pack quantity	1 pcs.

Status Archive