

## Mounting adapter for position sensors used on rising stem valves

ADAPTER\_VALVIS\_08

Status Archive

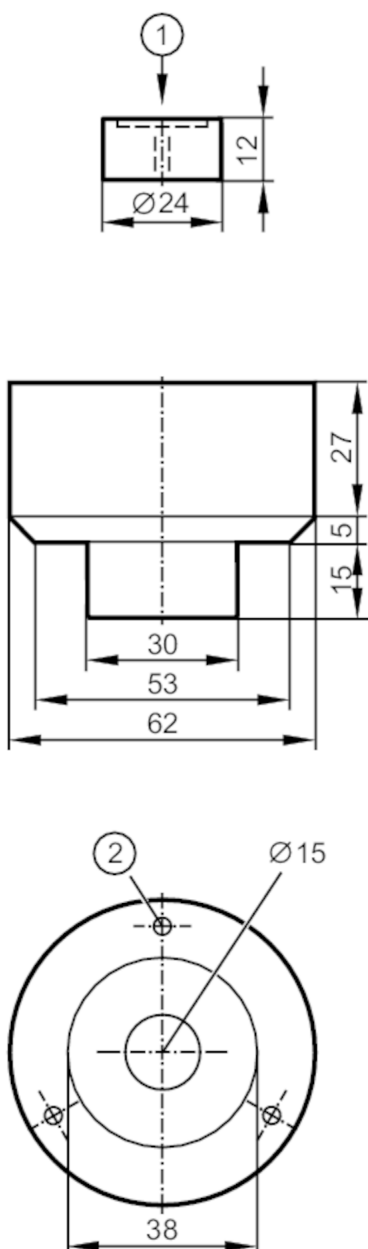

- 1 threaded hole M4 to fix the target on the valve piston  
 2 bore hole to fix the valve sensor on the adapter

### Application

Design accessories for IX5010, IX5030

### Mechanical data

Weight [g] 140

Materials Adapter: POM; Target: stainless steel

### Accessories

Accessories (supplied) screws: 3, thread forming

E12042



Mounting adapter for position sensors used on rising stem valves

ADAPTER\_VALVIS\_08

Remarks	
Notes	discontinued article
Pack quantity	1 pcs.

Status Archive