

Mounting adapter for position sensors used on rising stem valves

ADAPTER VALVIS 09

Status Archive

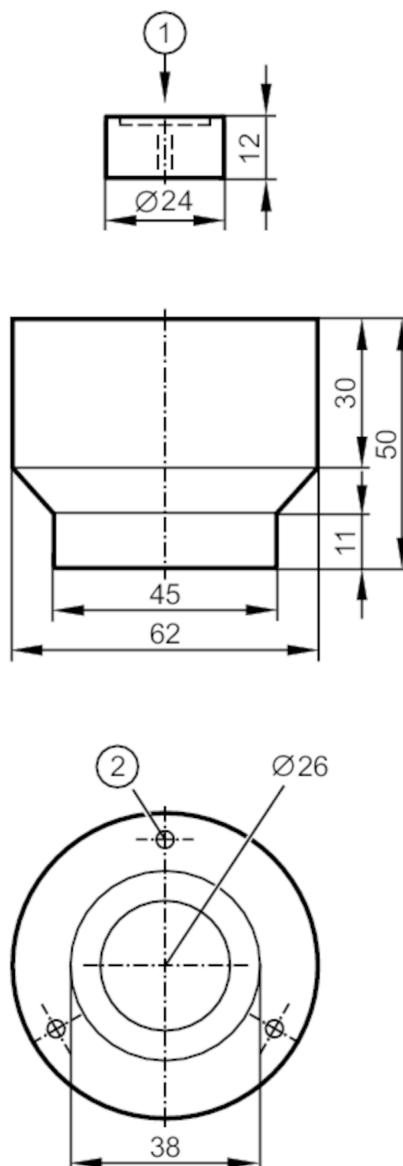

- 1 threaded hole M5 to fix the target on the valve piston
 2 bore hole to fix the valve sensor on the adapter

Application

Design accessories for IX5010, IX5030

Mechanical data

Weight [g] 180

Materials Adapter: POM; Target: stainless steel

Accessories

Accessories (supplied) screws: 3, thread forming

E12043



Mounting adapter for position sensors used on rising
stem valves

ADAPTER VALVIS 09

Remarks	
Notes	discontinued article
Pack quantity	1 pcs.

Status Archive