

OG5127

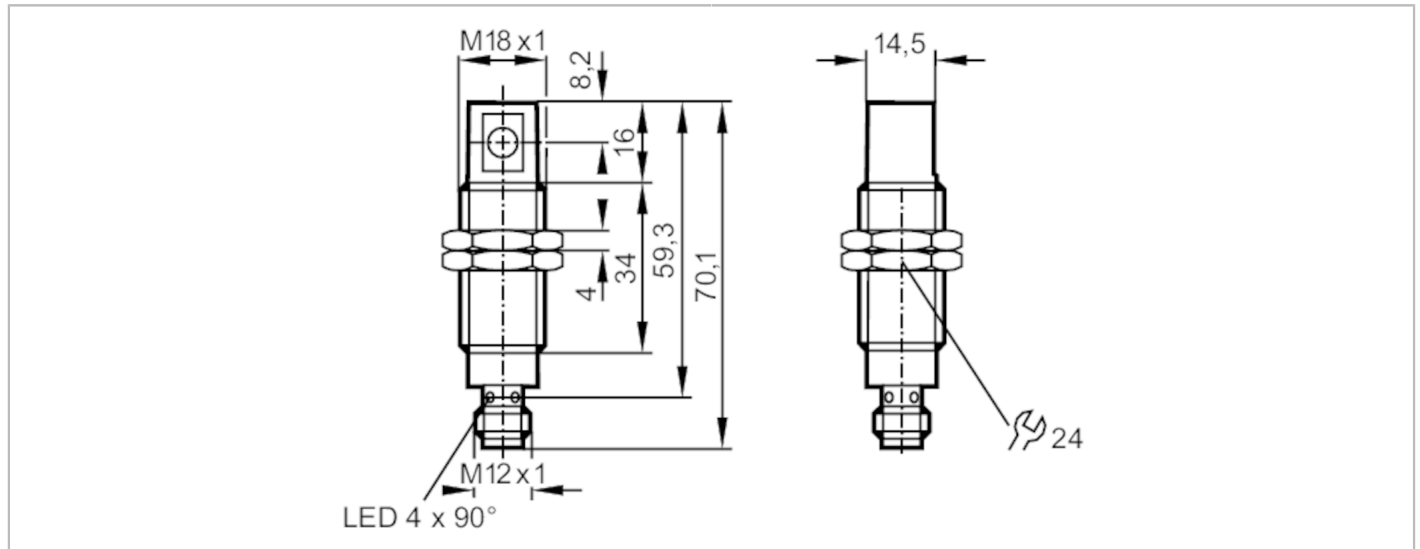

Through-beam sensor receiver

OGE-HPKG/US/90°



Application	
Function principle	Through-beam sensor
Electrical data	
Operating voltage [V]	10...30 DC; ("supply class 2" to cULus)
Current consumption [mA]	< 12
Protection class	II
Reverse polarity protection	yes
Type of light	red light
Wave length [nm]	660
Outputs	
Electrical design	PNP
Output function	light-on mode
Max. voltage drop switching output DC [V]	2.5
Permanent current rating of switching output DC [mA]	200
Switching frequency DC [Hz]	500
Short-circuit protection	yes
Type of short-circuit protection	pulsed
Overload protection	yes
Detection zone	
Transmitter / receiver	receiver
Range [m]	< 9
Range adjustable	no
Operating conditions	
Ambient temperature [°C]	-25...60
Protection	IP 68

OG5127



Through-beam sensor receiver

OGE-HPKG/US/90°

Tests / approvals

EMC	EN 60947-5-2	
	EN 55011	class B
MTTF [years]	953	

Mechanical data

Weight [g]	65.4
Housing	threaded type
Dimensions [mm]	M18 x 1 / L = 59.3
Thread designation	M18 x 1
Materials	stainless steel; ABS
Lens material	PMMA

Displays / operating elements

Display	switching status	1 x LED, yellow
	operation	1 x LED, green

Accessories

Accessories (supplied)	Nuts: 2 x lock washers: 2 x
------------------------	--------------------------------

Remarks

Pack quantity	1 pcs.
---------------	--------

Electrical connection

Connector: 1 x M12



Connection

