

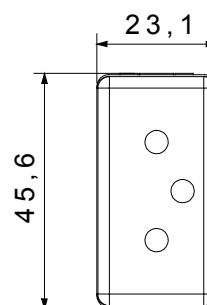

The System modular devices make it possible to create infinite combination between devices and plates, thanks to a complete range that is able to satisfy all design, functional and installation requirements. Colour and finiture: glossy white, bright and versatile. Ideal for flush-mounting solutions (for rectangular or square boxes), surface-mounting solutions, and for special applications. The range includes commands, socket-outlets, protection, indicators, connectors and devices for the control, safety and comfort of your home. NOTES: contact Gewiss customer service to check if the product meets the regulations of the country concerned before purchasing it. The socket is no longer compliant with Swiss standard SEV1011 of 2009.

| | | | |
|---|------------------------------|--|--------------------------------|
| Category | Socket-Outlet | Description | 2P+E - 10A - type 12 |
| Colour | Black | Voltage | 250 V ac |
| Earth pit | - | Standard | Swiss |
| Characteristics | - | For plug pins | Ø 4 mm |
| Wiring terminals | With screw | Standard | IEC 60884-1 |
| Resistance at test voltage | 2000 V at 50 Hz for 1 minute | Prolonged operation switch (no. of position changes) | 10.000 at In 250 V ac cosφ=0,8 |
| Thermo-pressure with ball | 125 °C | Glow Wire Test | 850 °C |
| Terminal grip on cable traction | > 50 N | Terminal tightening capacity stranded cables (mm²) | min. 0,75 - max. 2x4 |
| Terminal tightening capacity solid cables (mm²) | min. 0,5 - max. 2x2,5 | No. SYSTEM modules | 1 |
| Material | Technopolymer | Electrocod | 0131 |

DIMENSIONAL

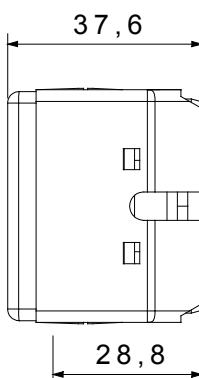
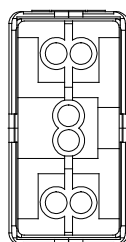

TECHNICAL SYMBOLOGY



STANDARDS/APPROVALS

