



70 RT HP is a complete offer of rotary isolator switches from 16 A to 160 A, available in boxes both in insulating material and aluminium, in control or emergency versions, compatible with the main applications for residential, tertiary and industrial contexts.

DC versions for photovoltaic applications are also available from 16 A to 40 A in insulating box.

The series is completed with versions for board from 16 A to 1000 A and for DIN rail fixing from 16 A to 63 A, which can be equipped with auxiliary contacts.

The devices have been designed to reduce wiring time, facilitate installation and guarantee the maximum safety and robustness even in the most demanding conditions.

ELECTRICAL CHARACTERISTICS

Circuit breaker	Rotary isolator	Version	For board
Rated current (A)	400	No. of modules EN 50022	14
No. of poles	4P	Regulation field	161 - 256 mm
Rated operational current AC-21A (415 V) (A)	400	Type	Control
Rated operational current AC-22A (415 V) (A)	400	Knob colour	Black
Rated operational current AC-23A (415 V) (A)	400	Lockable	YES (max. 3 locks in OFF)
Power dissipation per pole	26 W/pole	ACCESSORIES	
Cable section	1x185-2x185 mm ²	Type of accessory	Max. 8 auxiliary contacts (4 per side)

DIMENSIONAL

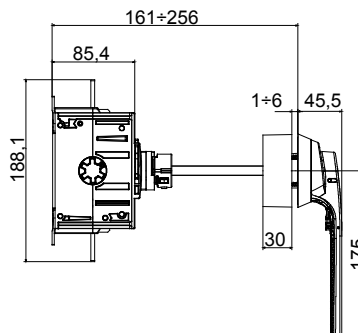
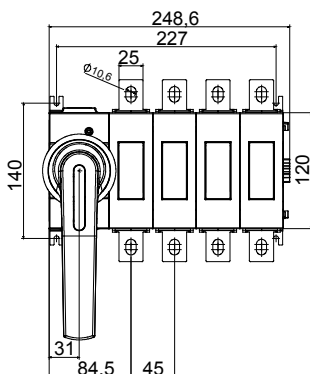

STANDARDS/APPROVALS

