

# SBU625

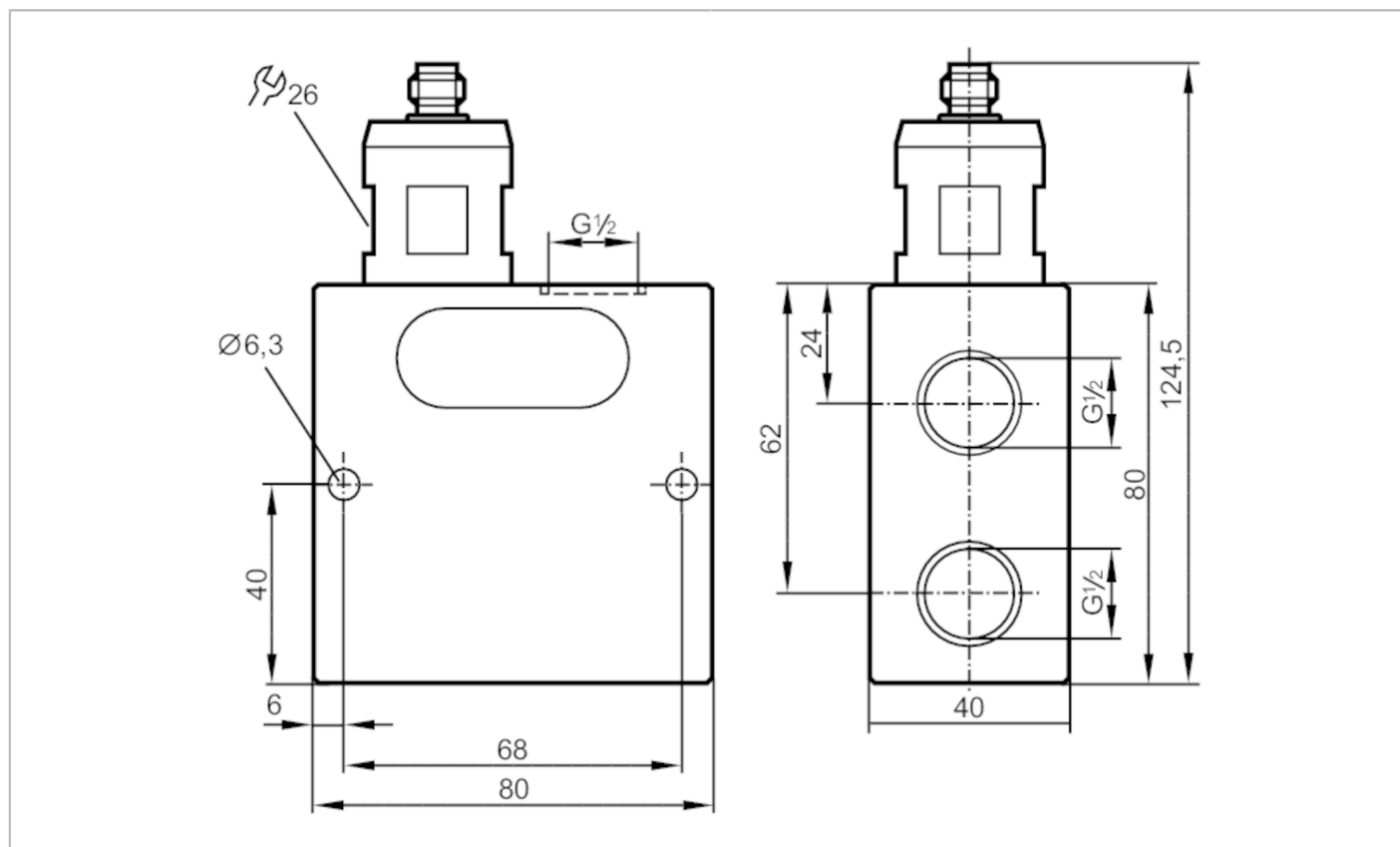

## Flow transmitter with integrated backflow prevention

SBU12DI040KG/US



| Application                 |         |  |
|-----------------------------|---------|--|
| Application                 |         | machine tools; Internal cooling of drill |
| Medium temperature          | [°C]    | 0...60                                   |
| Pressure rating             | [bar]   | 200                                      |
| Electrical data             |         |  |
| Operating voltage tolerance | [%]     | -15...10                                 |
| Operating voltage           | [V]     | 24 DC; (to SELV/PELV)                    |
| Current consumption         | [mA]    | 10                                       |
| Protection class            |         | III                                      |
| Reverse polarity protection |         | yes                                      |
| Outputs                     |         |  |
| Output signal               |         | analogue signal                          |
| Analogue voltage output     | [V]     | 0.5...10                                 |
| Min. load resistance        | [Ω]     | 10000                                    |
| Short-circuit protection    |         | yes                                      |
| Overload protection         |         | yes                                      |
| Measuring/setting range     |         |  |
| Measuring range             | [l/min] | 0.3...75                                 |
| Flow range                  | [l/min] | 75                                       |



## Flow transmitter with integrated backflow prevention

SBU12DI040KG/US

| Accuracy / deviations       |   |  |
|-----------------------------|---|--|
| Repeatability               |   | 1  |
| [% of the final value]      |   |  |
| Measuring error             |   | ± 5  |
| [% of the final value]      |   |  |
| Response times              |   |  |
| Response time               | [s]   | < 0.01   |
| Operating conditions        |   |  |
| Ambient temperature         | [°C]  | 0...60   |
| Storage temperature         | [°C]  | -15...80   |
| Protection                  |   | IP 65; IP 67   |
| Tests / approvals           |   |  |
| EMC                         | DIN EN 61000-6-2  |  |
|                             | DIN EN 61000-6-3  |  |
| Shock resistance            | DIN EN 60068-2-27   | 20 g (11 ms)   |
| Vibration resistance        | DIN EN 60068-2-6  | 5 g (10...2000 Hz)   |
| MTTF                        | [years]   | 15.78  |
| Mechanical data             |   |  |
| Weight                      | [g]   | 729.6  |
| Materials                   |   | aluminium anodised; PA   |
| Materials (wetted parts)    |   | stainless steel (1.4401 / 316); brass; aluminium anodised; PU; O-ring: FKM |
| Process connection          |   | G 1/2  |
| Switching cycles mechanical |   | 10 million   |
| Accessories                 |   |  |
| Accessories (supplied)      |   | sealing plugs  |
| Remarks                     |   |  |
| Remarks                     | Temperature changes slightly affect the specified standard settings for coolants. |  |
|                             | For oils, the settings are influenced by temperature and viscosity.               |  |
|                             | Recommendation Use 200 micron filtration  |  |
|                             | All data refer to coolants (20 °C).   |  |
| Pack quantity               |   | 1 pcs.   |
| Electrical connection       |   |  |
| Connector: 1 x M12          |   |  |
|                             |   |  |

# SBU625



## Flow transmitter with integrated backflow prevention

SBU12DI040KG/US

### Connection

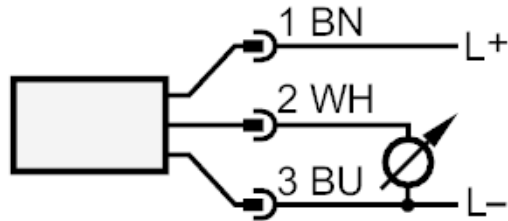

colours to DIN EN 60947-5-2

Core colours :

|      |       |
|------|-------|
| BN = | brown |
| BU = | blue  |
| WH = | white |