

ZCKM1H7

limit switch body ZCKM - 1NO+1NC - snap
action - 1/2"NPT

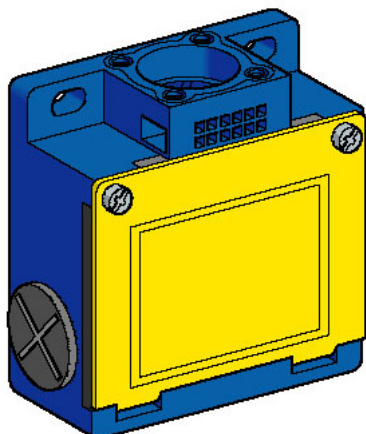

Main

| | |
|---------------------------------------|---|
| Range of product | OsiSense XC |
| Series name | Standard format |
| Product or component type | Limit switch body |
| Device short name | ZCKM |
| Body type | Fixed |
| Product compatibility | XCKM |
| Local display | Without |
| Electrical connection | Screw-clamp terminals , clamping capacity: 1 x 0.34...2 x 1.5 mm ² |
| Cable entry | 3 entries tapped for 1/2" NPT cable gland |
| Number of poles | 2 |
| Contacts type and composition | 1 NO + 1 NC |
| Contacts operation | Snap action |
| Positive opening | With |
| Ambient air temperature for operation | -25...70 °C for standard environment |
| Environmental characteristic | Standard environment |

Complementary

| | |
|--|---|
| Associated head | ZCKD02 ZCKD05 ZCKD06 ZCKD08 ZCKD10 ZCKD109 ZCKD15 ZCKD16 ZCKD17 ZCKD21 ZCKD219 ZCKD23 ZCKD239 ZCKD29 ZCKD41 ZCKD59 ZCKD81 ZCKD91 |
| Body material | Metal |
| Number of steps | 1 |
| Contacts material | Silver plated contacts |
| Minimum actuation speed | 0.01 m/min |
| Contact code designation | A300 , AC-15 (Ue = 240 V , Ie = 3 A), Ithe = 10 A conforming to EN/IEC 60947-5-1 appendix A Q300 , DC-13 (Ue = 250 V , Ie = 0.27 A) conforming to EN/IEC 60947-5-1 appendix A |
| [Ui] rated insulation voltage | 300 V conforming to UL 508 contact block 300 V conforming to CSA 22-2 No 14 contact block 500 V degree of pollution 3 conforming to IEC 60947-1 contact block |
| Resistance across terminals | 0.25 mOhm conforming to IEC 60255-7 category 3 |
| [Uimp] rated impulse withstand voltage | 6 kV conforming to IEC 60947-1 6 kV conforming to IEC 60664 |
| Short circuit protection | 10 A by gG cartridge fuse |

The information provided in this documentation contains general descriptions and/or technical characteristics of the performance of the products contained herein. This documentation is not intended as a substitute for and is not to be used for determining suitability or reliability of these products for specific user applications. It is the duty of any such user or integrator to perform the appropriate and complete risk analysis, evaluation and testing of the products with respect to the relevant specific application or use thereof. Neither Schneider Electric Industries SAS nor any of its affiliates or subsidiaries shall be responsible or liable for misuse of the information contained herein.

| | |
|-----------------------|---|
| Electrical durability | 5000000 cycles , DC-13 (Uc = 48 V), 7 W , load factor: 0.5 , operating rate: < 60 cyc/mn conforming to IEC 60947-5-1 appendix C 5000000 cycles , DC-13 (Uc = 120 V), 4 W , load factor: 0.5 , operating rate: < 60 cyc/mn conforming to IEC 60947-5-1 appendix C 5000000 cycles , DC-13 (Uc = 24 V), 10 W , load factor: 0.5 , operating rate: < 60 cyc/mn conforming to IEC 60947-5-1 appendix C |
| Width | 30 mm |
| Height | 63 mm |
| Depth | 64 mm |
| Product weight | 0.21 kg |

Environment

| | |
|-------------------------------------|-------------------|
| IP degree of protection | IP65 |
| IK degree of protection | IK08 |
| Ambient air temperature for storage | -40...70 °C |
| RoHS EUR conformity date | 4Q2009 |
| RoHS EUR status | Will be compliant |