

# ZCKM7H29

limit switch body ZCKM - 2NC - slow-break - M20

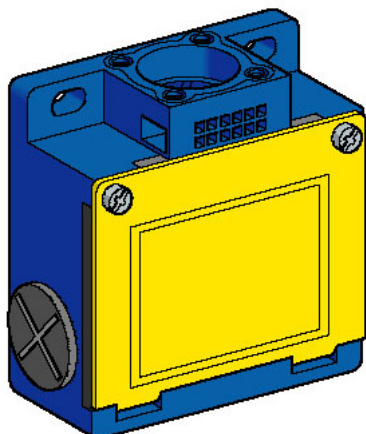

## Main

Range of product	OsiSense XC
Series name	Standard format
Product or component type	Limit switch body
Device short name	ZCKM
Body type	Fixed
Product compatibility	XCKM
Local display	Without
Electrical connection	Screw-clamp terminals , clamping capacity: 1 x 0.5...2 x 2.5 mm <sup>2</sup>
Cable entry	3 entries tapped for M20 x 1.5 cable gland
Number of poles	2
Contacts type and composition	2 NC
Contacts operation	Slow-break Slow-break, simultaneous
Positive opening	With
Ambient air temperature for operation	-25...70 °C for standard environment
Environmental characteristic	Standard environment

## Complementary

Associated head	ZCKD02 ZCKD05 ZCKD06 ZCKD08 ZCKD10 ZCKD109 ZCKD15 ZCKD16 ZCKD17 ZCKD21 ZCKD219 ZCKD23 ZCKD239 ZCKD29 ZCKD41 ZCKD59 ZCKD81 ZCKD91
Body material	Metal
Number of steps	1
Contacts material	Silver plated contacts
Minimum actuation speed	6 m/min
Contact code designation	A300 , AC-15 (U <sub>e</sub> = 240 V , I <sub>e</sub> = 3 A), I <sub>the</sub> = 10 A conforming to EN/IEC 60947-5-1 appendix A Q300 , DC-13 (U <sub>e</sub> = 250 V , I <sub>e</sub> = 0.27 A) conforming to EN/IEC 60947-5-1 appendix A
[Ui] rated insulation voltage	300 V conforming to UL 508 contact block 300 V conforming to CSA 22-2 No 14 contact block 500 V degree of pollution 3 conforming to IEC 60947-1 contact block
Resistance across terminals	0.25 mOhm conforming to IEC 60255-7 category 3
[Uimp] rated impulse withstand voltage	6 kV conforming to IEC 60947-1 6 kV conforming to IEC 60664
Short circuit protection	10 A by gG cartridge fuse

Electrical durability	5000000 cycles , DC-13 (Uc = 48 V), 9 W , load factor: 0.5 , operating rate: < 60 cyc/mn conforming to IEC 60947-5-1 appendix C 5000000 cycles , DC-13 (Uc = 120 V), 7 W , load factor: 0.5 , operating rate: < 60 cyc/mn conforming to IEC 60947-5-1 appendix C 5000000 cycles , DC-13 (Uc = 24 V), 13 W , load factor: 0.5 , operating rate: < 60 cyc/mn conforming to IEC 60947-5-1 appendix C
Product weight	0.21 kg

## Environment

IP degree of protection	IP65
IK degree of protection	IK08
Ambient air temperature for storage	-40...70 °C
RoHS EUR conformity date	4Q2009
RoHS EUR status	Will be compliant