

ZCKMD35H7

limit switch body ZCKM - 1NO+2NC - slow-break - 1/2"NPT

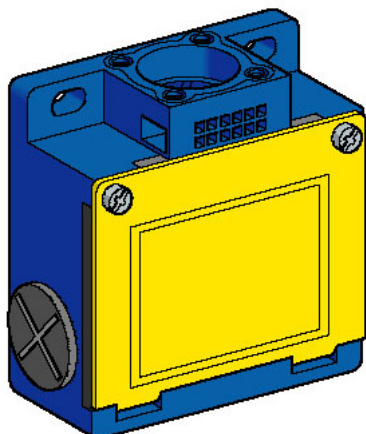

Main

Range of product	OsiSense XC
Series name	Standard format
Product or component type	Limit switch body
Device short name	ZCKM
Body type	Fixed
Product compatibility	XCKM
Local display	Without
Electrical connection	Screw-clamp terminals , clamping capacity: 1 x 0.34...2 x 0.75 mm ²
Cable entry	3 entries tapped for Pg 11 cable gland
Number of poles	3
Contacts type and composition	2 NC + 1 NO
Contacts operation	Slow-break
Positive opening	With
Ambient air temperature for operation	-25...70 °C for standard environment
Environmental characteristic	Standard environment

Complementary

Associated head	ZCKD02 ZCKD05 ZCKD06 ZCKD08 ZCKD10 ZCKD109 ZCKD15 ZCKD16 ZCKD17 ZCKD21 ZCKD219 ZCKD23 ZCKD239 ZCKD29 ZCKD41 ZCKD59 ZCKD81 ZCKD91
Body material	Metal
Number of steps	1
Contacts material	Silver plated contacts
Minimum actuation speed	6 m/min
Contact code designation	B300 , AC-15 (U _e = 240 V , I _e = 1.5 A) , I _{the} = 6 A conforming to EN/IEC 60947-5-1 appendix A R300 , DC-13 (U _e = 250 V , I _e = 0.1 A) conforming to EN/IEC 60947-5-1 appendix A
[Ui] rated insulation voltage	300 V conforming to UL 508 contact block 300 V conforming to CSA 22-2 No 14 contact block 400 V degree of pollution 3 conforming to IEC 60947-1 contact block
Resistance across terminals	0.25 mOhm conforming to IEC 60255-7 category 3
[Uimp] rated impulse withstand voltage	4 kV conforming to IEC 60947-1 4 kV conforming to IEC 60664
Short circuit protection	6 A by gG cartridge fuse

The information provided in this documentation contains general descriptions and/or technical characteristics of the performance of the products contained herein. This documentation is not intended as a substitute for and is not to be used for determining suitability or reliability of these products for specific user applications. It is the duty of any such user or integrator to perform the appropriate and complete risk analysis, evaluation and testing of the products with respect to the relevant specific application or use thereof. Neither Schneider Electric Industries SAS nor any of its affiliates or subsidiaries shall be responsible or liable for misuse of the information contained herein.

Electrical durability	5000000 cycles , DC-13 (Uc = 24 V), 4 W , load factor: 0.5 , operating rate: < 60 cyc/mn conforming to IEC 60947-5-1 appendix C 5000000 cycles , DC-13 (Uc = 48 V), 3 W , load factor: 0.5 , operating rate: < 60 cyc/mn conforming to IEC 60947-5-1 appendix C 5000000 cycles , DC-13 (Uc = 120 V), 2 W , load factor: 0.5 , operating rate: < 60 cyc/mn conforming to IEC 60947-5-1 appendix C
Width	30 mm
Height	63 mm
Depth	64 mm
Product weight	0.21 kg

Environment

IP degree of protection	IP65
IK degree of protection	IK08
Ambient air temperature for storage	-40...70 °C
RoHS EUR conformity date	4Q2009
RoHS EUR status	Will be compliant