

# ZCKY61

limit switch lever ZCKY - forked arm with rollers  
2 tracks - (-40°C)

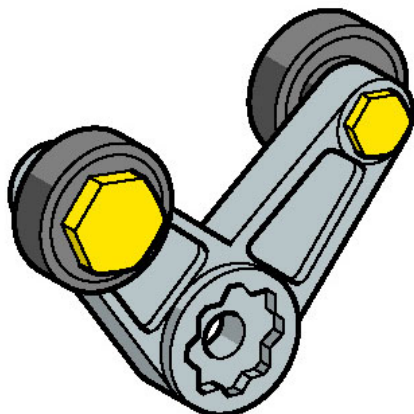

## Main

Range of product	OsiSense XC
Series name	Standard format
Product or component type	Limit switch lever
Device short name	ZCKY
Product compatibility	XCKJ
Associated head	ZCKE09
Type of operator	Thermoplastic stay put forked arm with rollers (2 tracks)
Positive opening	Without
Environmental characteristic	Low temperature Standard environment

## Complementary

Movement of operating head	Rotary
Switch actuation	By specific cam
Type of approach	Lateral approach

## Environment

Ambient air temperature for operation	-40...20 °C for low temperature -25...70 °C for standard environment
Ambient air temperature for storage	-25...70 °C for standard environment -25...70 °C for low temperature
RoHS EUR conformity date	0903
RoHS EUR status	Compliant

The information provided in this documentation contains general descriptions and/or technical characteristics of the performance of the products contained herein. This documentation is not intended as a substitute for and is not to be used for determining suitability or reliability of these products for specific user applications. It is the duty of any such user or integrator to perform the appropriate and complete risk analysis, evaluation and testing of the products with respect to the relevant specific application or use thereof. Neither Schneider Electric Industries SAS nor any of its affiliates or subsidiaries shall be responsible or liable for misuse of the information contained herein.